

**For difficult case of complete denture!**

Resin for repair of denture base  
Peripheral extension and functional relining material  
"Perifit"

**Improves peripheral and mucous membrane surface of the denture base at the same time, just like a tissue conditioner.**

# Perifit

PAT.

FOR EXTENSION OF BORDERS AND  
FUNCTIONAL IMPRESSION LININGS OF DENTURE BASE

**It works as a tissue conditioner on the first day, and gradually starts hardening from the next day as a functional relining material.**

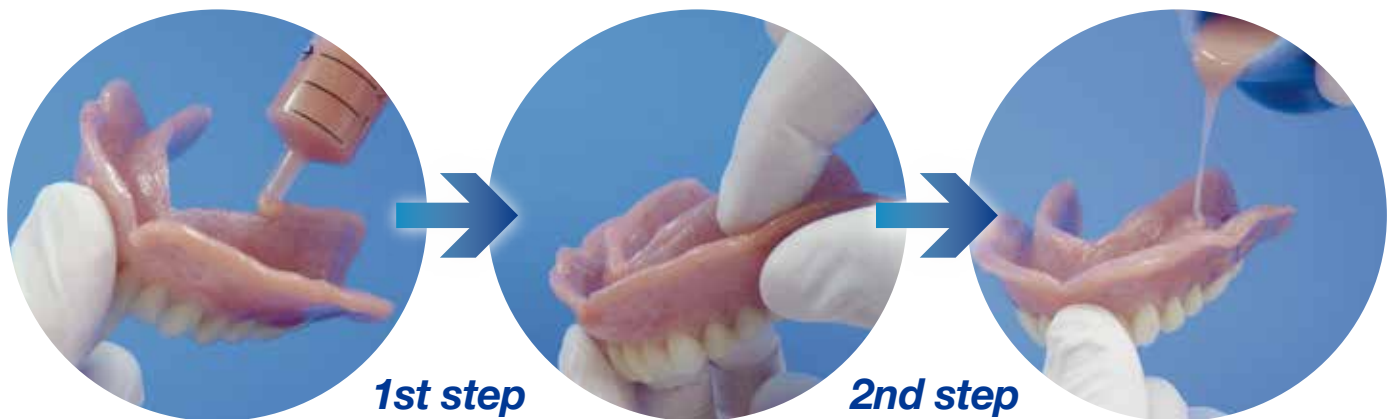

**1st step**  
(Extension of the peripheral edge)  
Spread "Perifit" to the peripheral edge of dentures

**2nd step**  
(Functional relining)  
Rough shaping of peripheral edge

**3rd step**  
(Functional relining)  
Spread "Perifit" to the inner surface of the base



## 《Characteristics》

**1st step** (Extension of the Peripheral edge of the base)

**Spread resin to the peripheral edge of dentures**

Shape the mold of the part that needs to be extended by fingers as hardening takes time.

**2nd step** (Functional relining)

**Relining of the denture base by using a functional impression**

"Perifit" is soft like a tissue conditioner at the beginning, it doesn't cause much pain so that the relined denture can fit easily.

Contents of a set: Powder 36g, liquid 30mL, "New Top Coat" 10mL, Syringe 1, other. Color: Pink, Live pink (with fiber)

KAMEMIZU CHEM.IND.CO.,LTD.

# Perifit

FOR EXTENSION OF BORDERS AND  
FUNCTIONAL IMPRESSION LININGS OF DENTURE BASE

For extension of borders and functional impression linings of denture base

## Perifit PAT.

Functional impression lining material

### 《Characteristics》

1. This product can be used for the peripheral extension, sealing as well as lining of a denture base by only changing the ratio of powder to liquid.
2. Gum rarely sores from a denture  
At the beginning, resin is soft as a tissue conditioner, and hardening gradually starts the next day.
3. No irritation, No heat generation

### 《Usage》

Denture extension, sealing and lining of peripheral by functional impression method. (Especially suitable to free-end saddle dentures, and complete dentures for difficult cases.)

### 《Color》

Pink  
Live pink (containing red fibers)

### 《Contents of a set 》

Powder	36 g
Liquid	30 mL
New Top Coat	10 mL
Syringe	1 pieces
Dropper	1 pieces
Measuring cup	} 1 each
Mixing cup	
Spatula	
Pressing stick	

### 《Procedures》



#### 1 Obtain a new denture base surface and apply bonding agent

Remove one layer of relining denture including peripheral edge of a denture base by a bar to obtain a new denture surface. Then, apply "New Top Coat" to the relining surface including peripheral edge of the denture base.



#### 2 Mix powder and liquid in the syringe

Using the ratio of powder to liquid for peripheral edge extension, put powder to the measuring scale of 2 (approx. 1.7 g) directly into the syringe, and add liquid measured by a dropper (measuring scale 1, approx. 1 mL) to the powder in the syringe.



#### 3 Spread resin to the peripheral edge

Mix powder and liquid quickly in the syringe (about 10 second), and wait a little until the mixture hardens enough not to hang down from the base. Timing of spreading varies according to each room temperature.



#### 4 After shaping roughly with fingers, practice the muscle trimming

Shape the mold of the part that needs to be extended by using wet fingers. Then, insert the relined denture into the mouth for the muscle trimming.



#### 5 Spread resin to the mucous membrane surface of the denture base

After finishing the muscle trimming, mix powder with the scale 3 (approx. 2.8 g) of the measuring cup and liquid with the scale 2.5 (approx. 2.5mL) of a dropper, which is the ratio for the mucous membrane surface, for 15 to 20 second, then spread the mixture to the mucous membrane surface of the denture base (1 to 2 minutes at 23°C of the room temperature after mixing well), and insert the denture into the mouth. Keep the denture in the mouth for 4 to 5 minutes.

In this process, please take care so that any excess materials will not flow into the throat.



#### 6 Apply the surface smoothing material

After the gelation, take the denture out of the mouth, trim any excess materials and dry it, and apply "New Top Coat" to the entire relined surface of the denture base to finish.

Please note that make sure to remove any undercut between teeth (embrasure) when correcting the form of the denture. The reason is that, if the lining materials get in the undercut, it will become difficult to take out the denture after hardening.

### Caution:

● As for any excess materials getting in the undercut or a space between teeth (embrasure), make sure to remove them, because it may be difficult to take out the denture after hardening that takes place the following day of the treatment.

● The relined denture is soft on the first day of wearing, so if a denture cleaner on the market is used it may cause rough surface. Therefore make sure to rinse the denture with water only on the first day of setting the relined denture.

And, from the next day, the denture may be cleaned using "Polident".



**Kamemizu Chemical Industry Co. Ltd.**

〒572-0071

17-16 Toyosato Neyagawa-city, Osaka, Japan

TEL+81-72-826-7720 FAX +81-72-826-1299

**(Inquiry)**

[http://kamemizu.co.jp/e\\_kamemizu](http://kamemizu.co.jp/e_kamemizu)

E-mail: [info@kamemizu.co.jp](mailto:info@kamemizu.co.jp)

